

# PRODUCT DATA SHEET

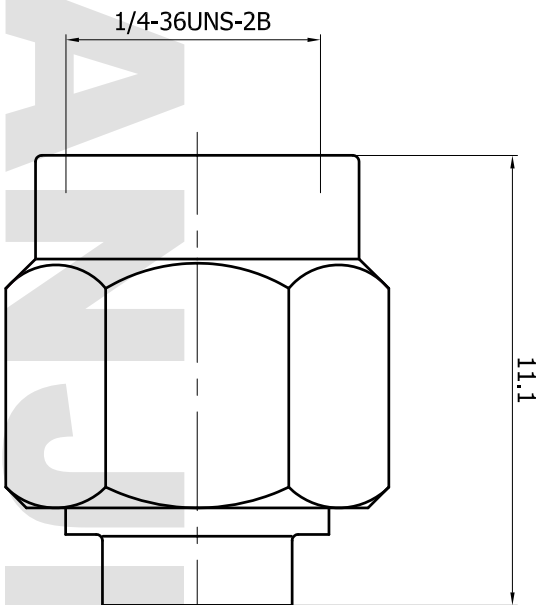

**MATERIAL:**  
BODY: BRASS  
CONTACT: BERYLLIUM COPPER  
INSULATOR: PTFE

**PERFORMANCE:**  
IMPEDANCE: 50 OHMS  
FREQUENCY: DC~ TO 18 GHZ  
VSWR:  $\leq 1.25$

THIS DOCUMENT CONTAINS CONFIDENTIAL AND PROPRIETARY INFORMATION THAT CANNOT BE REPRODUCED OR DIVULGED, IN WHOLE OR IN PART, WITHOUT WRITTEN AUTHORIZATION FROM "LANJIAN ELECTRONICS"

MATERIAL :		UNLESS OTHERWISE SPECIFIED: DIMENSIONS IN MM	
TOLERANCES :		ANGULAR : $\pm 1^\circ$	
XX	$\pm 0.20$	FILETS R/C :	$\pm 0.10$
XXX	$\pm 0.10$	SURFACE FINISH :	Ra 1.6
X.XXX	$\pm 0.01$	DEBURR AND BREAK SHARP EDGES	
NAME	DATE	SIGNATURE	
DRAWN X.C.W	12/21/2022		
CHKD H.Z.Y	12/21/2022		
APPRVD H.Z.Y	12/21/2022		
MFG			
PROJECTION	SIZE	SCALE	
	A3	8:1	

**LANJIAN ELECTRONICS**  
38 Hengtong Road, Xinqu Dingmao  
Zhenjiang, 212009, Jiangsu, P. R. China

TITLE  
**SMA-J141**

DWG No. GCP23.650.A.019  
DO NOT SCALE THE DRAWING

REV. A  
PAGE 1 / 1