

# PRODUCT DATA SHEET

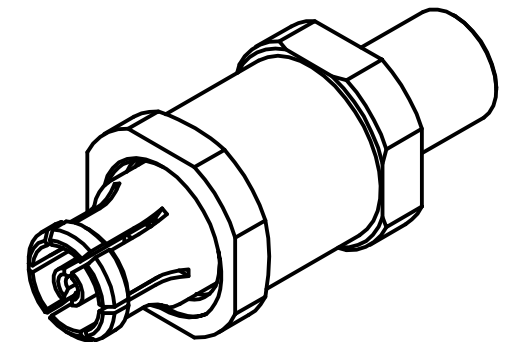
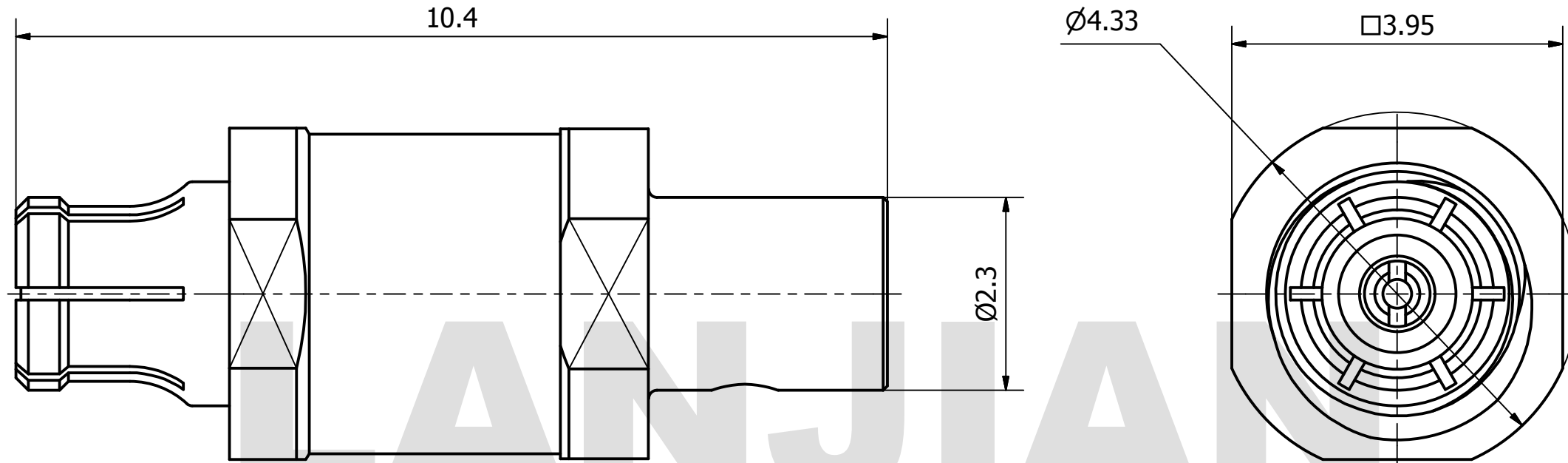

**MATERIAL:**  
 BODY: BERYLLIUM COPPER PER ASTM B196.  
 ALLOY NO. UNS C17300  
 CONTACT: BERYLLIUM COPPER PER ASTM B196.  
 ALLOY NO. UNS C17300  
 INSULATOR: PTFE PER ASTM D1710

**PERFORMANCE:**  
 IMPEDANCE: 50 OHMS  
 FREQUENCY: DC TO 40 GHz  
 VSWR: ≤ 1.35

THIS DOCUMENT CONTAINS CONFIDENTIAL AND PROPRIETARY INFORMATION THAT CANNOT BE REPRODUCED OR DIVULGED, IN WHOLE OR IN PART, WITHOUT WRITTEN AUTHORIZATION FROM "LANJIAN ELECTRONICS"	MATERIAL :			<b>LANJIAN ELECTRONICS</b> 38 Hengtong Road, Xinqu Dingmao Zhenjiang, 212009, Jiangsu, P. R. China		
	UNLESS OTHERWISE SPECIFIED: DIMENSIONS IN MM					
	TOLERANCES :			TITLE <b>SMPM-KY047</b> straight jack cable connector		
	X.X	± 0.10	ANGULAR : ± 30°			DEBURR AND BREAK SHARP EDGES
	X.XX	± 0.05	FILLETS R/C : ± 0.10			
	X.XXX	± 0.005	SURFACE FINISH : Ra 0.8			
	NAME	DATE	SIGNATURE	DWG No. GCPZ3.660.H.014 REV. A DO NOT SCALE THE DRAWING PAGE 1 / 1		
DRAWN	YaoJiang	10/29/2018				
CHK'D	HongZhongYan	10/29/2018				
APPV'D	HongZhongYan	10/29/2018				
MFG						
PROJECTION		SIZE	SCALE			
		A3	15 : 1			