

# PRODUCT DATA SHEET

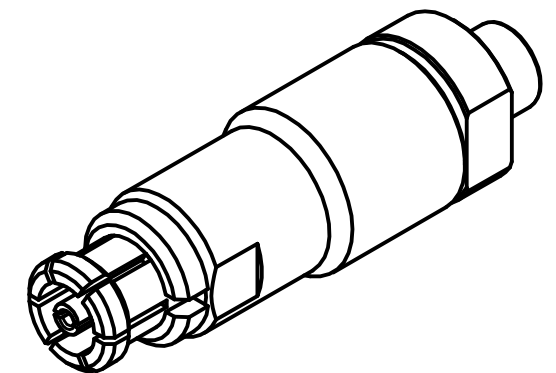
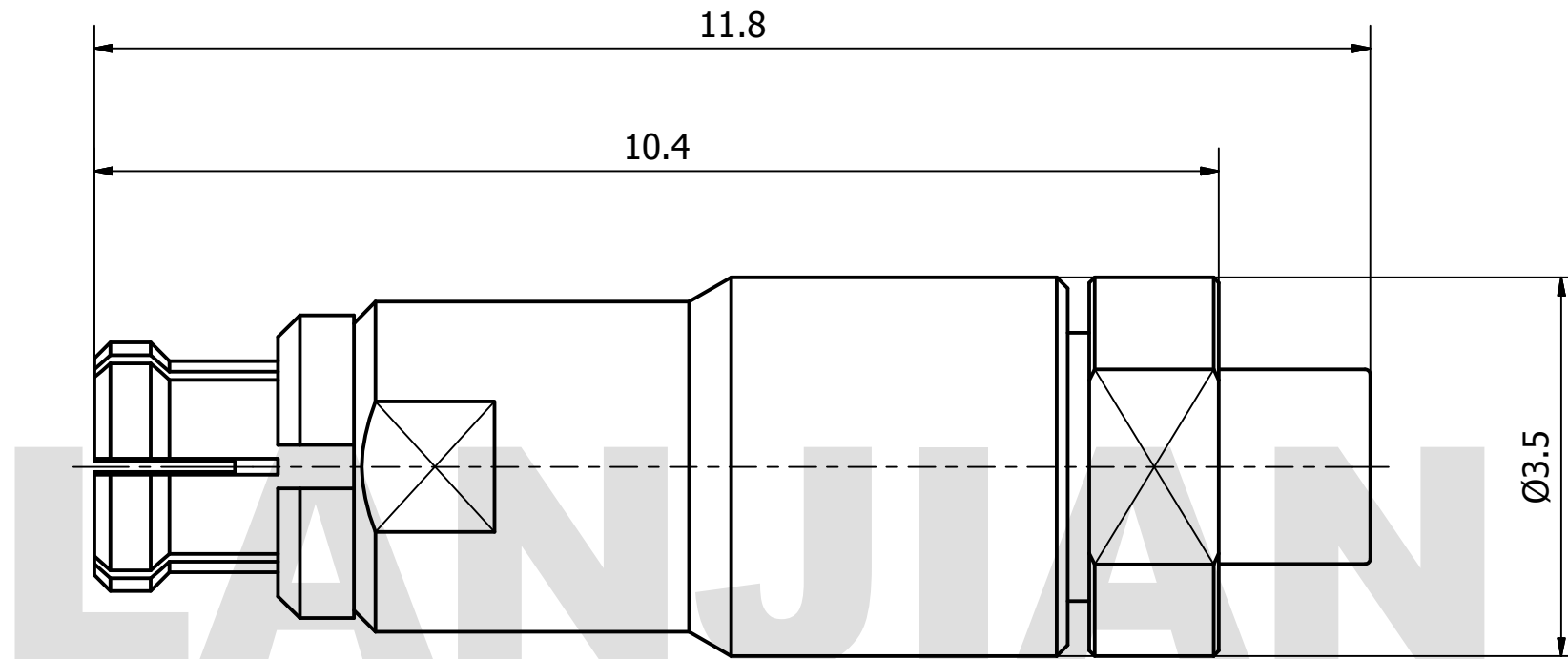

**MATERIAL:**  
 BODY: BERYLLIUM COPPER PER ASTM B196.  
 ALLOY NO. UNS C17300  
 CONTACT: BERYLLIUM COPPER PER ASTM B196.  
 ALLOY NO. UNS C17300  
 INSULATOR: PEI

**PERFORMANCE:**  
 IMPEDANCE: 50 OHMS  
 FREQUENCY: DC TO 40 GHz  
 VSWR: ≤1.25

THIS DOCUMENT CONTAINS CONFIDENTIAL AND PROPRIETARY INFORMATION THAT CANNOT BE REPRODUCED OR DIVULGED, IN WHOLE OR IN PART, WITHOUT WRITTEN AUTHORIZATION FROM "LANJIAN ELECTRONICS"	MATERIAL :		
	UNLESS OTHERWISE SPECIFIED: DIMENSIONS IN MM		
	TOLERANCES :		
	X.X	± 0.10	ANGULAR : ± 30'
	X.XX	± 0.05	FILLETS R/C : ± 0.10
	X.XXX	± 0.005	SURFACE FINISH : Ra 0.8
			DEBURR AND BREAK SHARP EDGES
		NAME	DATE
	DRAWN	YaoJiang	12/07/2018
	CHK'D	HongZhongYan	12/07/2018
APPV'D	HongZhongYan	12/07/2018	
MFG			
PROJECTION		SIZE	SCALE
		A3	15 : 1

38 Hengtong Road, Xinqu Dingmao  
Zhenjiang, 212009, Jiangsu, P. R. China

TITLE	
SMPM-K047R straight jack connector	
DWG No.	REV.
GCPZ3.660.H.009	A
DO NOT SCALE THE DRAWING	
PAGE 1 / 1	